

# MEIGSVILLE TOWNSHIP SECTION 27 R11 TWP 10 MORGAN COUNTY, OHIO

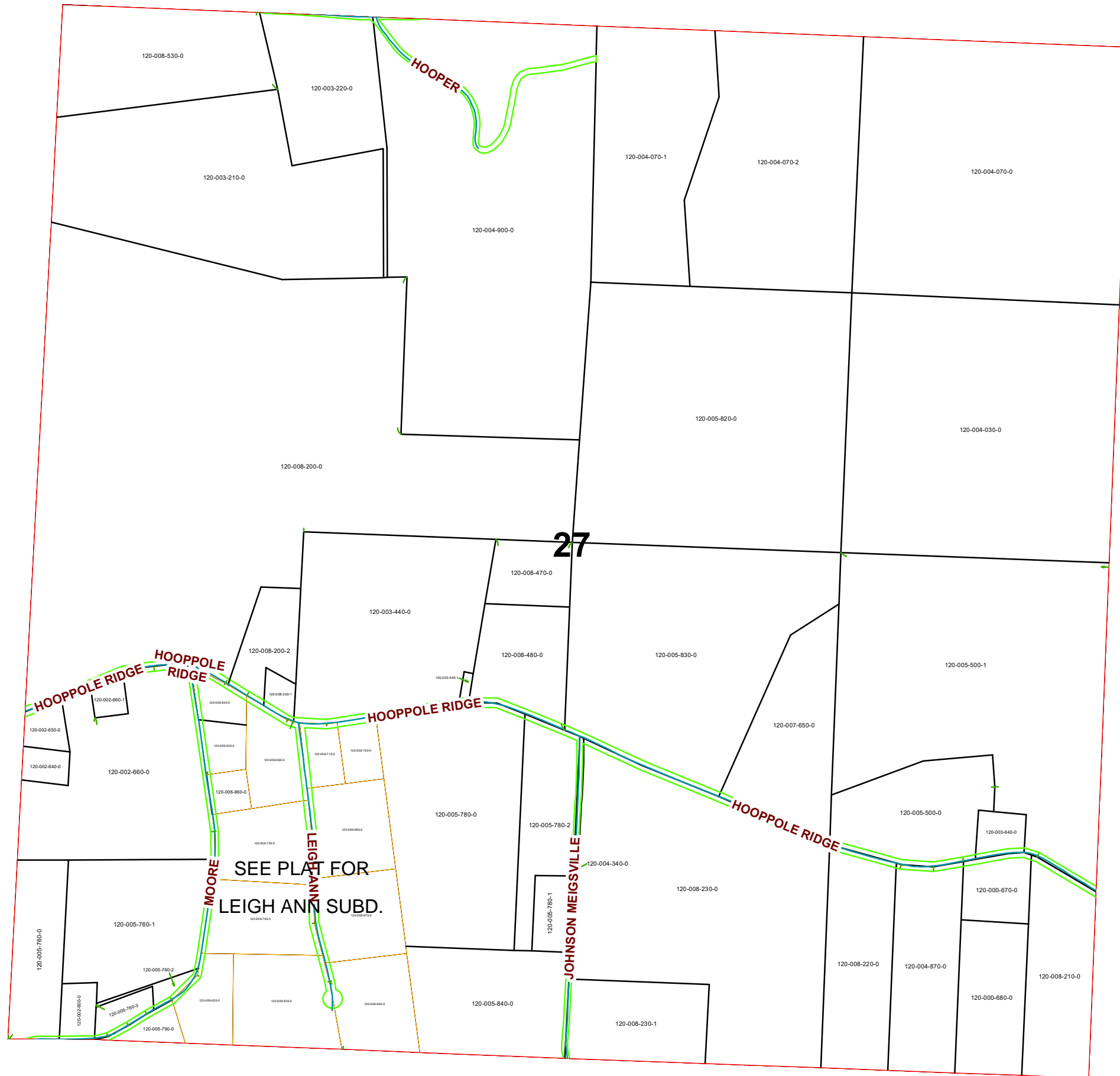

PIN	Owner	VOL	PAG	LegalDescr	Acres	Survey_Ref
120-008-220-0	BARTRUG SAMUEL L & MARTHA J	OR224	231	R11 T10 S27 SD 31	9.025	MIG-0007.pdf
120-002-640-0	DILLE ROGER & LINDA	D.V	137 587	R11 T10 S27 SD 28	1	NoSurvey.pdf
120-002-650-0	DILLE ROGER & LINDA	D.V	123 633	R11 T10 S27 SD 29	1.174	NoSurvey.pdf
120-002-660-0	DILLE ROGER & LINDA LOU	D.V	142 417	R11 T10 S27 SD 29	17.37	MIG-0001.pdf
120-002-660-1	DILLE RONNIE A & LORI	OR35	31	R11 T10 S27 SD 45	0.8	MIG-0211.pdf
120-000-670-0	GARBER JEREMY A & ASHLEY S	OR224	2047	R11 T10 S27 SD 33	2.7	MIG-0007.pdf
120-003-210-0	GUSTAFAN PAUL G JR	OR57	66	R11 T10 S27 SD 3	28.16	NoSurvey.pdf
120-003-220-0	GUSTAFAN PAUL G JR	OR57	66	R11 T10 S27 SD 22-	9.67	NoSurvey.pdf
120-000-680-0	HANN DARLA K	OR117	113	R11 T10 S27 SD 35	6.45	MIG-0016.pdf
120-004-070-1	HOOPER JARED W & SHERYL D	D.V	187 119	R11 T10 S27 S D 41	17.271	MIG-0268.pdf
120-008-530-0	HOOPER JEDIDIAH J & GENEVIEVE	OR220	1702	R11 T10 S27 SD 17	12.61	MIG-0184.pdf
120-004-070-2	HOOPER MAVIS D	OR72	403	R11 T10 S27 SD 50	25.351	MIG-0269.pdf
120-004-030-0	J & S HOOPER FARMS, LLC	OR223	3091	R11 T10 S27 SD 11	42.25	NoSurvey.pdf
120-004-070-0	J & S HOOPER FARMS, LLC	OR223	3091	R11 T10 S27 SD 1	41.629	NoSurvey.pdf
120-004-870-0	KINNEY WILLIAM K & JANET	D.V	147 325	R11 T10 S27 SD 32	8.715	MIG-0007.pdf
120-004-900-0	KISSELL RODNEY M & PAMELA P	D.V	145 121	R11 T10 S27 SD 2-2	51.6	NoSurvey.pdf
120-002-600-0	KUTSCHERENKO TROY J	OR55	616	R11 T10 S27 SD 40	1.261	MIG-0095.pdf
120-008-200-0	MASSEY BRIAN W & THERESA J LE- E	OR230	460	R11 T10 S27 SD 14	94.327	MIG-0446.pdf
120-005-500-0	MATSON PHILLIP A & JOLENE K	OR216	437	R11 T10 S27 SD 10	8.074	MIG-0148.pdf
120-005-760-3	MOORE BRIAN PAUL & TERESA DAW	OR202	3435	R11 T10 S27 SD 49	1.142	NoSurvey.pdf
120-005-760-2	MOORE BRIAN PAUL & TERESA DAW	OR202	3435	R11 T10 S27 SD 44	0.741	MIG-0176.pdf
120-005-780-0	MOORE THOMAS M & SUSANA SHEE	OR141	275	R11 T10 S27 SD 8	19.544	NoSurvey.pdf
120-005-830-0	MOORE THOMAS M & SUSANA SHEE	OR141	275	R11 T10 S27 SD 9	29.85	NoSurvey.pdf
120-005-820-0	MOORE THOMAS M & SUSANA SHEE	OR141	275	R11 T10 S27 SD 19	41.5	NoSurvey.pdf
120-005-840-0	MOORE THOMAS MICHAEL & DIANE	D.V	169 197	R11 T10 S27 SD 39	10.471	MIG-0074.pdf
120-005-790-0	MURPHY JAMES E & CASSIE L	OR168	316	R11 T10 S27 SD 30	1.28	MIG-0002.pdf
120-005-780-1	PAIGE RODNEY A & MELINDA F	OR74	549	R11 T10 S27 SD 51	1.835	MIG-0274.pdf
120-005-780-2	PAIGE RODNEY A & MELINDA F	OR125	579	R11 T10 S27 SD 53	6.18	MIG-0309.pdf
120-003-440-0	SAYA TOVICH NICHOLAS	OR232	189	R11 T10 S27 SD 18	20.649	MIG-0486.pdf
120-007-650-0	SHEETS REX W & SUSAN A	D.V	156 191	R11 T10 S27 SD 38	10.43	MIG-0032.pdf
120-004-340-0	SHIFLETT MARGARET JOHNSON & RO	OR 222	2867	R11 T10 S27 SD 15	0.64	NoSurvey.pdf
120-008-210-0	STEVENS CHARLES E	D.V	193 177	R11 T10 S27 SD 34	8.68	MIG-0007.pdf
120-005-500-1	STRELECKI GEORGE I JR	D.V	201 79	R11 T10 S27 SD 42	40.113	MIG-0156.pdf
120-003-640-0	STRELECKI GEORGE JR	OR213	1586	R11 T10 S27 SD 25	1.243	MIG-0154.pdf
120-008-230-0	THOMPSON ANITA LYNN & GEORGE I	OR206	462	R11 T10 S27 SD 12	36.167	NoSurvey.pdf
120-003-440-1	WAITE DONALD O & MARY A	OR48	799	R11 T10 S27 SD 46	0.184	MIG-0227.pdf
120-008-480-0	WAITE DONALD O & MARY A	D.V	178 200	R11 T10 S27 SD 37	6.35	MIG-0407.pdf
120-008-470-0	WAITE DONALD O & MARY A	D.V	178 200	R11 T10 S27 SD 36	3.27	MIG-0407.pdf
120-008-230-1	WAY NATHAN A	OR232	1225	R11 T10 S27 SD48	7.033	MIG-0415.pdf
120-008-200-1	WILLIG CHRISTOPH	OR228	820	R11 T10 S27 SD 47	0.77	MIG-0257.pdf
120-008-200-2	WILLIG CHRISTOPH	OR228	820	R11 T10 S27 SD 54	3.782	MIG-0422.pdf
120-005-760-1	WOLFE TODD W	OR175	268	R11 T10 S27 SD 43	11.096	MIG-0266.pdf
120-005-760-0	WORK ETHAN A	OR216	1749	R11 T10 S27 SD 7	5.775	MIG-0266.pdf

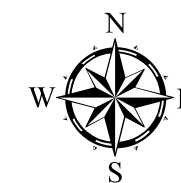

Boundaries	
	Hydro
	Section
	Roads
	Lot
	Township
	County
	Parcel
	ROW

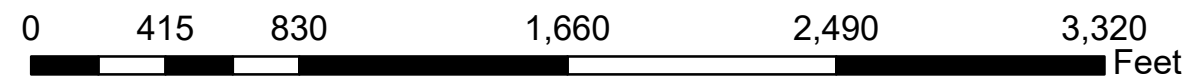

Disclaimer: The information that these maps contains is for reference purposes only. Please bring any erros to the attention of the Engineer's Office staff. Thank you